

Board
to
board

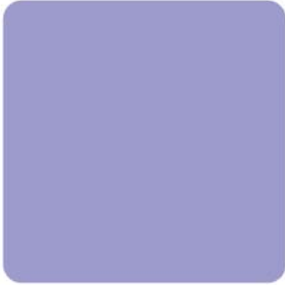

Greenconn ▶

Product selection guide
2016 - 17

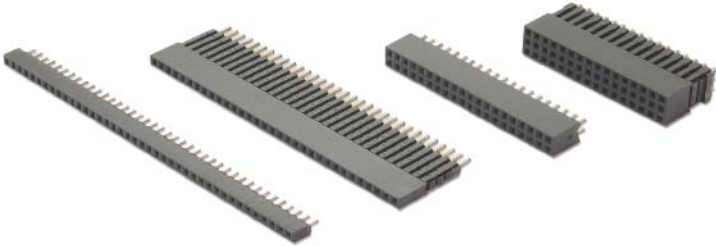
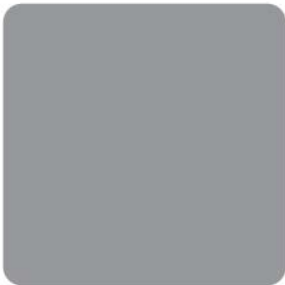

www.greenconn.com

solution for pitch 5.08mm

Board to Board



▶ Pin Header

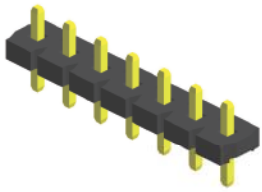

GPM101 Series

H01



GPM102 Series

H02

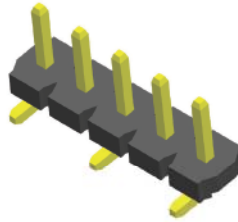

GPMC103 Series

H03

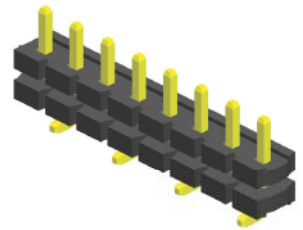

GPMC104 Series

H04

▶ Female Header

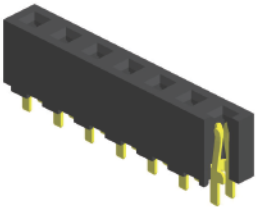

CSMA110 Series

H05

Pin Header

pitch 5.08mm (0.20") | Single row | Dip

GPMA101 Series

Specifications

Current Rating : 7.9 Ampere
 Insulation Resistance : 1000 MΩ Min
 Dielectric Withstanding : 1500V AC
 Contact Resistance : 20 mΩ Max
 Operating Temperature : -40°C to +105°C

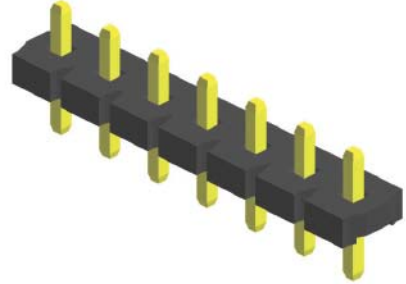

Materials

Contact Material : Brass
 Insulation Material : High Temperature Thermoplastic, 94V-0 LCP

All materials must meet Greenconn's requirements for environmental protection.

Mating with

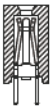
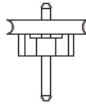

H05

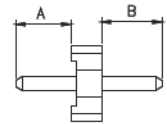
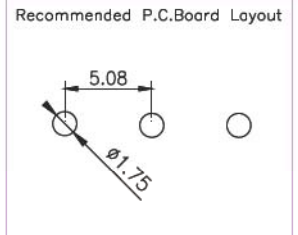
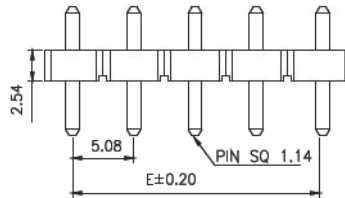

* For Coded Dimension Not Inside The Table, Please Refer To "Ordering Information"

No. of Pins/Row	Dimension Information		No. of Pins/Row	Dimension Information	
	D	E		D	E
02	10.16	5.08	11	55.88	50.80
03	15.24	10.16	12	60.96	55.88
04	20.32	15.24	13	66.04	60.96
05	25.40	20.32	14	71.12	66.04
06	30.48	25.40	15	76.20	71.12
07	35.56	30.48	16	81.28	76.20
08	40.64	35.56	17	86.36	81.28
09	45.72	40.64	18	91.44	86.36
10	50.80	45.72	19	96.52	91.44
			20	101.60	95.62

Ordering Information

GPMA1

Height Option (H) Standard

01

-

No. of Pins per Row

02

1

20

Standard Plating

02 : Gold Flash

Selective Plating

01 : Tin

Standard Packaging : Box

C1BA

A

Pin Length (A/B)

008 : A=4.55 / B=3.80

010 : A=3.00 / B=11.00

For special length requirement
 Please contact our sales personnel

Pin Header

pitch 5.08mm (0.20") | Single row | R/A

GPMB101 Series

Specifications

Current Rating :	7.9 Ampere
Insulation Resistance :	1000 MΩ Min
Dielectric Withstanding :	1500V AC
Contact Resistance :	20 mΩ Max
Operating Temperature :	-40°C to +105°C

Materials

Contact Material :	Brass
Insulation Material :	High Temperature Thermoplastic, 94V-0 LCP

All materials must meet Greenconn's requirements for environmental protection.



Mating with

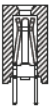
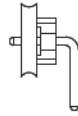

H05

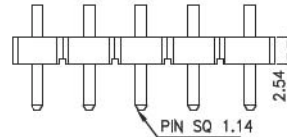

Recommended P.C.Board Layout

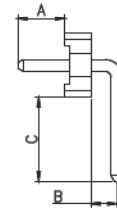
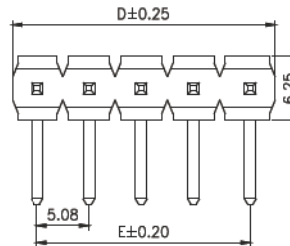
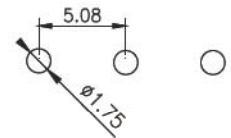

* For Coded Dimension Not Inside The Table, Please Refer To "Ordering Information"

No. of Pins/Row	Dimension Information		No. of Pins/Row	Dimension Information	
	D	E		D	E
02	10.16	5.08	11	55.88	50.80
03	15.24	10.16	12	60.96	55.88
04	20.32	15.24	13	66.04	60.96
05	25.40	20.32	14	71.12	66.04
06	30.48	25.40	15	76.20	71.12
07	35.56	30.48	16	81.28	76.20
08	40.64	35.56	17	86.36	81.28
09	45.72	40.64	18	91.44	86.36
10	50.80	45.72	19	96.52	91.44
			20	101.60	96.52

Ordering Information

GPMB1

Height Option (H) Standard

01

-

No. of Pins per Row

02

1

20

Standard Plating

02 : Gold Flash

Selective Plating

01 : Tin

Standard Packaging : Tube

C1BC

A

Pin Length (A/B/C)

001 : A=4.55 / B=2.54 / C=8.10

005 : A=3.95 / B=4.95 / C=13.80

For special length requirement
Please contact our sales personnel

Pin Header

pitch 5.08mm (0.20") | Single row | S.M.T.

GPMC103 Series

Specifications

Current Rating : 7.9 Ampere
 Insulation Resistance : 1000 MΩ Min
 Dielectric Withstanding : 1500V AC
 Contact Resistance : 20 mΩ Max
 Operating Temperature : -40°C to +105°C

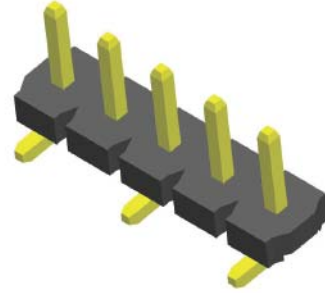

Materials

Contact Material : Brass
 Insulation Material : High Temperature Thermoplastic, 94V-0 LCP

All materials must meet Greenconn's requirements for environmental protection.

Mating with

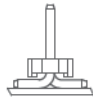

H05

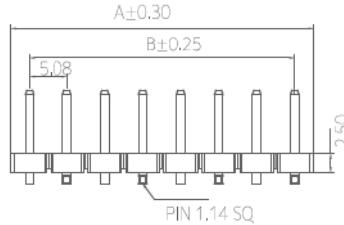

Recommended P.C.Board Layout

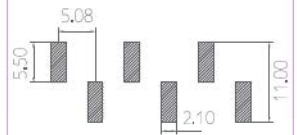

* For Coded Dimension Not Inside The Table, Please Refer To "Ordering Information"

No. of Pins/Row	Dimension Information		No. of Pins/Row	Dimension Information	
	D	E		D	E
02	10.16	5.08	11	55.88	50.80
03	15.24	10.16	12	60.96	55.88
04	20.32	15.24	13	66.04	60.96
05	25.40	20.32	14	71.12	66.04
06	30.48	25.40	15	76.20	71.12
07	35.56	30.48	16	81.28	76.20
08	40.64	35.56	17	86.36	81.28
09	45.72	40.64	18	91.44	86.36
10	50.80	45.72	19	96.52	91.44
			20	101.60	95.62

Ordering Information

GPMC1

Height Option (H) Standard

03

-

No. of Pins per Row

02

1

20

Standard Plating

02 : Gold Flash

Selective Plating

01 : Tin

05 : Gold Flash / Tin

Standard Packaging : Tube

C1BC

A Pin Length (C/D/E)

003 : A= 8.50 / B=4.05 / C=10.00

004 : A=11.75 / B=5.73 / C= 8.40

010 : C= 2.00 / D=1.60 / E= 4.80

For special length requirement
 Please contact our sales personnel

Pin Header

pitch 5.08mm (0.20") | Single row | S.M.T. | Board spacer

GPMC104 Series

Specifications

Current Rating : 7.9 Ampere
 Insulation Resistance : 1000 MΩ Min
 Dielectric Withstanding : 1500V AC
 Contact Resistance : 20 mΩ Max
 Operating Temperature : -40°C to +105°C

Materials

Contact Material : Brass
 Insulation Material : High Temperature Thermoplastic, 94V-0 LCP

All materials must meet Greenconn's requirements for environmental protection.

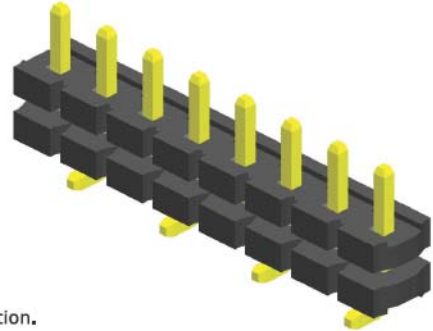

Mating with

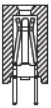

H05

Recommended P.C.Board Layout

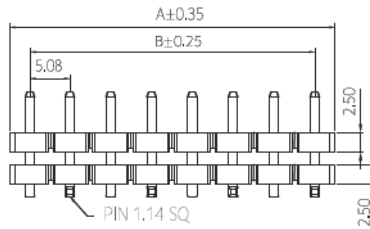
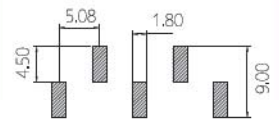

* For Coded Dimension Not Inside The Table, Please Refer To "Ordering Information"

No. of Pins/Row	Dimension Information		No. of Pins/Row	Dimension Information	
	D	E		D	E
02	10.16	5.08	11	55.88	50.80
03	15.24	10.16	12	60.96	55.88
04	20.32	15.24	13	66.04	60.96
05	25.40	20.32	14	71.12	66.04
06	30.48	25.40	15	76.20	71.12
07	35.56	30.48	16	81.28	76.20
08	40.64	35.56	17	86.36	81.28
09	45.72	40.64	18	91.44	86.36
10	50.80	45.72	19	96.52	91.44
			20	101.60	96.52

Ordering Information

GPMC1

Height Option (H) Standard

04

-

No. of Pins per Row

02

1

20

Standard Plating

02 : Gold Flash

Standard Packaging : Tube

C1BC

A

Pin Length (C/D/E)

004 : A=5.00 / B=8.00 / C=8.00

For special length requirement
Please contact our sales personnel

Female Header

pitch 5.08mm (0.20") | Single row | Dip

CSMA110 Series

Specifications

Current Rating : 7.9 Ampere
 Insulation Resistance : 1000 MΩ Min
 Dielectric Withstanding : 1500V AC
 Contact Resistance : 20 mΩ Max
 Operating Temperature : -40°C to +105°C

Materials

Contact Material : Phosphor Bronze
 Insulation Material : High Temperature Thermoplastic, 94V-0 LCP

All materials must meet Greenconn's requirements for environmental protection

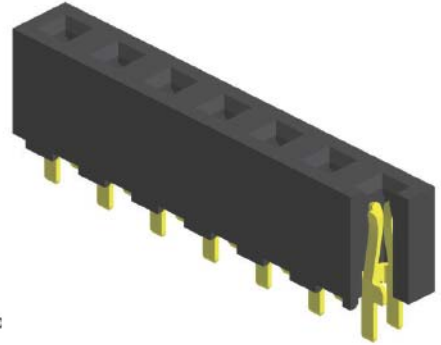

Mating with

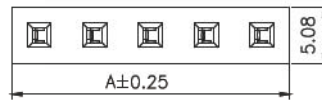
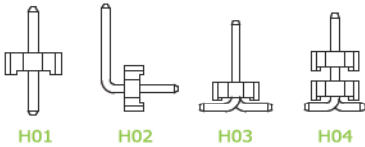

Recommended P.C.Board Layout

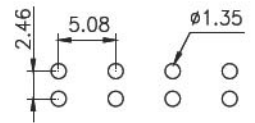

P.S. : Suggested mating pin length : 3.8 ~ 8.5 mm

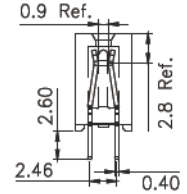
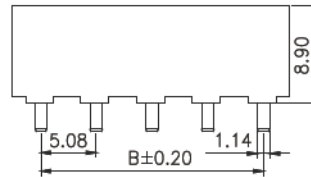

No. of Pins/Row	Dimension Information		No. of Pins/Row	Dimension Information	
	A	B		A	B
02	10.16	5.08	11	55.88	50.80
03	15.24	10.16	12	60.96	55.88
04	20.32	15.24	13	66.04	60.96
05	25.40	20.32	14	71.12	66.04
06	30.48	25.40	15	76.20	71.12
07	35.56	30.48	16	81.28	76.20
08	40.64	35.56	17	86.36	81.28
09	45.72	40.64	18	91.44	86.36
10	50.80	45.72	19	96.52	91.44
			20	101.60	96.52

Ordering Information

Standard Packaging : Tube

CSMA1

Height Option (H) Standard

10

-

No. of Pins per Row

02

↑

20

Standard Plating

02 : Gold Flash

Selective Plating

01 : Tin

A001C1AC



Taiwan Greenconn Corporation

5F., No.657-3, Zhongzheng Road, Xingzhuang Dist., New Taipei City 242, Taiwan
Tel : + 886 - 2 - 2209 1343 Fax : + 886 - 2 - 2903 0754

China Greenconn Technology (Shenzhen) Co., Ltd.

No.181-1, Yanluo Road, Songgang Town, Baoan District, Shenzhen City, Guangdong Province, China,
Tel : + 86 - 755 - 2707 0050 / 1 Fax : + 86 - 755 - 2707 0056

Kunshan Greenconn Technology Co., Ltd.

No.18-2 Hong-Yang South Road, Bacheng Town, Kunshan City, Jiangsu Province, China
Tel : + 86 - 512 - 5782 5636 Fax : + 86 - 512 - 5031 6595

Ge Lin Electronic Science & Technology (Ganzhou) Co., Ltd.

The Dongshan Industrial District, Wenfeng Road, Nankang Zone, Ganzhou City, Jiangxi Province, China
Tel : + 86 - 797 - 6635 510 Fax : + 86 - 797 - 6635 653

