

**P/N: WTL6R24358RH**  
**7.0\*3.0\*1.5/ceramic filter**



## APPROVAL SHEET

DESCRIPTION :	7.0*3.0*1.5mm ceramic filter
NOMINAL FREQ.:	10.700MHz
WTL P/N:	WTL6R24358RH
WTL MODEL:	ZTC
REVISION:	1
DATE:	2017.11.23

<b>Customer</b>	<b>Customer P/N</b>
IBS Technology Int'l HK Ltd	/

Signature	WTL
	Approved by: <i>Xo Xo Lee</i>
	Checked by: <i>Susan He</i>
	Issued by: <i>Shengbiao</i>

### REVISION HISTORY

Revised Page	Revision Content	Date	Ref. No.	Reviser

**深圳市维拓精电科技有限公司**

**WTL International Limited**

**Tel: 86-755-8267 7582 Fax:86-755-82679302**

**www.wtlcrystals.com email: wt1006@wtlcrystals.com**

**P/N: WTL6R24358RH**  
**7.0\*3.0\*1.5/ceramic filter**



1. SCOPE

This specification shall cover the characteristics of the ceramic filter with the type WTL6R24358RH

2. PART NO.

PART NUMBER	PREVIOUS PART NUMBER
WTL6R24358RH	
CUSTOMER PART NO	SPECIFICATION NO

3. OUTLINE DIMENSIONS AND MARK

3.1 Appearance: No visible damage and dirt.

3.2 Construction: SMD ceramic packaging.

3.3 The products conform to the RoHS directive and national environment protection law.

3.4 Dimensions and mark

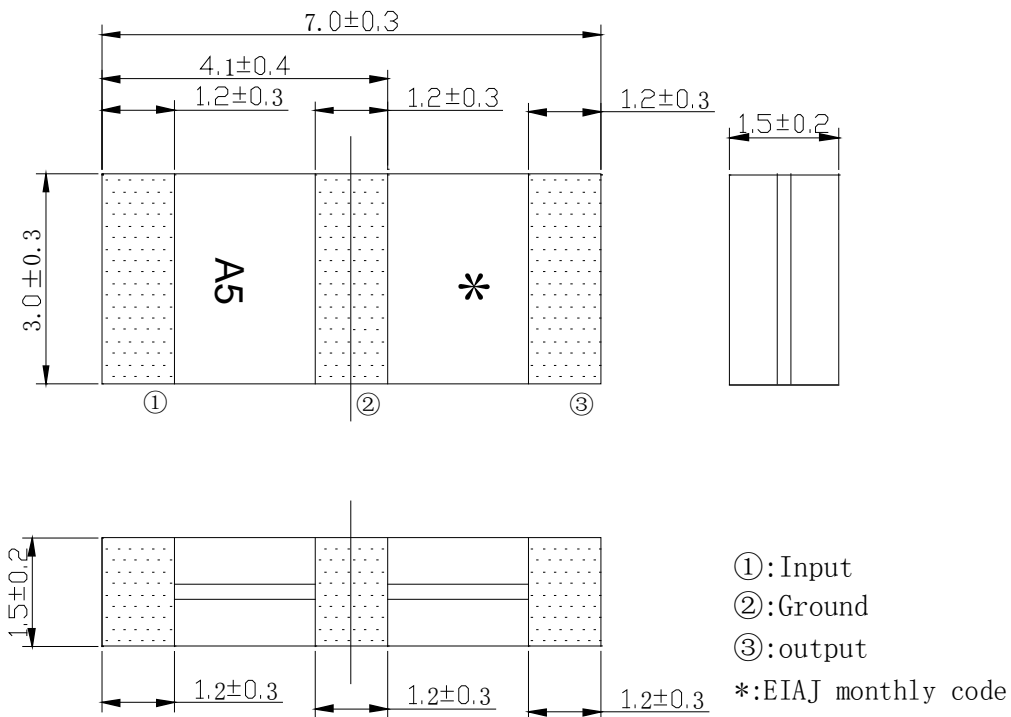

3.5 Structure

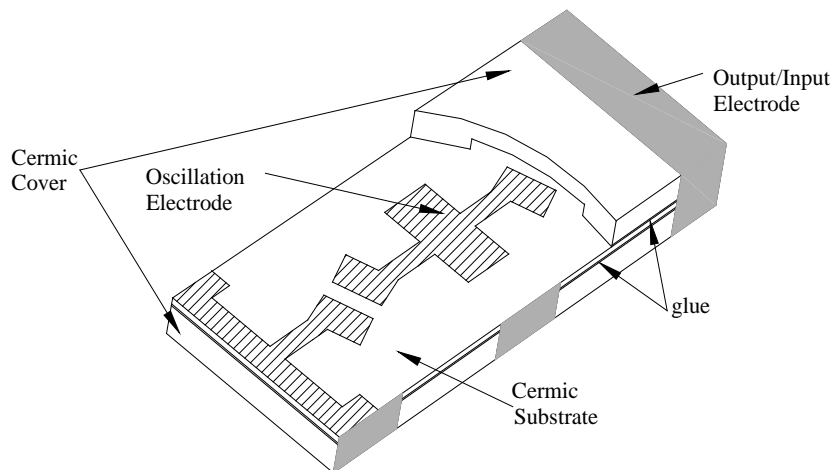

#### 4 ELECTRICAL SPECIFICATIONS

##### 4.1 RATING

Items	Content
Withstanding Voltage (V)	50 (DC, 1min)
Insulation Resistance Ri, (MΩ) min.	100 (10V, 1min)
Operating Temperature Range (°C)	-20~+80
Storage Temperature Range (°C)	-40~+85

##### 4.2 ELECTRICAL SPECIFICATIONS

Items	Content
Center Frequency(fo)(MHz)	10.700±0.030
3dB Bandwidth(kHz)	280±50
20dB Bandwidth(kHz) max	590
Insertion Loss (dB)	3.0±2.0 (at minimum loss point)
Ripple (dB) max	1.0 (within 3dB Bandwidth)
Spurious Attenuation (dB) min	35 (9MHz-12MHz)
Input/Output Impedance(Ω)	330
Temp. Characteristic	±0.5% (-20°C to 80°C )

#### 5. TEST

##### 5.1 Test Conditions

Parts shall be tested under the condition ( Temp.: 20±15°C, Humidity : 65±20% R.H.) unless the standard condition(Temp.: 25±2°C, Humidity : 65±5% R.H.)

**P/N: WTL6R24358RH**  
**7.0\*3.0\*1.5/ceramic filter**



is regulated to measure.

5.2 Test Circuit

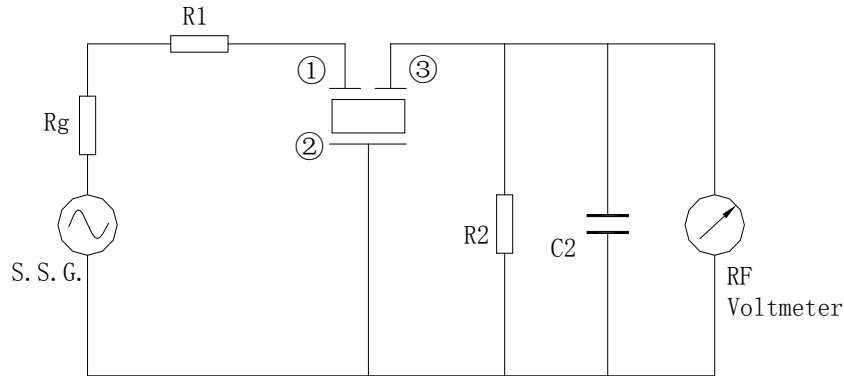

R1=280 Ω ± 5%, R2=330Ω±5%, Rg=50Ω ①:Input  
 C2=10 Pf (Including stray capacitance and capacitance of RF Voltmeter) ②:Ground  
 S.S.G:Output Voltmeter ③:Output

6. ENVIRONMENTAL TEST

No.	Item	Condition of Test	Performance Requirement	
6.1	Humidity	Subject the filter at 40 ± 2 °C and 90%-95% R.H. for 96h, Filter shall be measured after being placed in natural conditions for 1h.	It shall fulfill Table 1.	
6.2	High Temperature Exposure	Subject the filter to 85 ± 2 °C for 96h, Filter shall be measured after being placed in natural conditions for 1h.	It shall fulfill Table 1.	
6.3	Low Temperature Exposure	Subject the filter to -40 ± 2 °C for 96h, Filter shall be measured after being placed in natural conditions for 1h.	It shall fulfill Table 1.	
6.4	Temperature Cycling	After temperature cycling of blow table was performed 5 times, Filter shall be measured after being placed in natural conditions for 1h.	It shall fulfill Table 1.	
		Temperature		Time
		-20 ± 3 °C		30 ± 3 min
		80 ± 3 °C	30 ± 3 min	
6.5	Vibration	Subject the filter to vibration for 2h.Each in x y and z axis with the amplitude of 1.5mm, The frequency shall be varied uniformly between the limits of 10Hz-55Hz-10Hz and then filter shall be measured.	It shall fulfill Table 1.	
6.6	Mechanical Shock	Filter shall be measured after 3 times random dropping from the height of 1m on wooden plate.	No visible damage and it shall fulfill Table 1.	

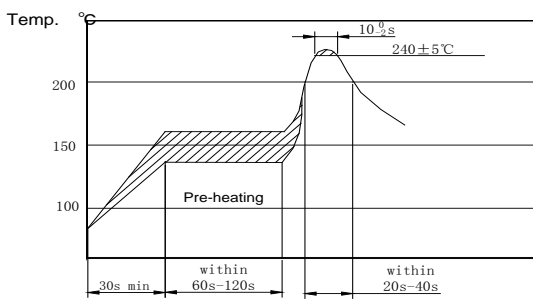
6.7	Soldering Test	<p>Passed through the re-flow oven under the following condition and left at room temperature for 24h before measurement.</p> 	It shall fulfill Table 1.
-----	----------------	--	---------------------------

(to be continued)

**6. ENVIRONMENTAL TEST**

No.	Item	Condition of Test	Performance Requirements
6.8	Solderability	Dipped in 235°C±5°C solder bath for 3s±0.5s with rosin flux (25wt% ethanol solution.)	The terminals shall be at least 95% covered by solder.
6.9	Board Bending	<p>Mount on a glass-epoxy board (width =50mm, thickness=1.6mm), then bend it to 1mm displacement (velocity=1mm/s) and keep it for 5s.</p> 	Mechanical damage such as break shall not occur

Table 1

Item	Characteristics after test
Center Frequency Drift ( kHz) max	± 30
Insertion Loss Drift (dB) max	± 2
3dB Bandwidth Drift (kHz) max	± 25
20dB Bandwidth Drift (kHz) max	± 60
Note: The limits in the above table are referenced to the initial measurements.	

**P/N: WTL6R24358RH**  
**7.0\*3.0\*1.5/ceramic filter**

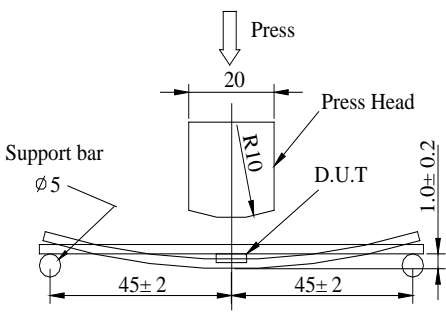

7 RECOMMENDED LAND PATTERN AND REFLOW SOLDERING STANDARD CONDITIONS

7.1 Recommended land pattern

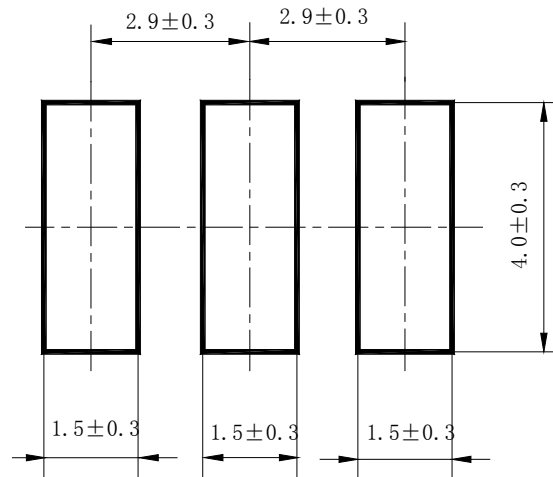

7.2 Recommended reflow soldering standard condition

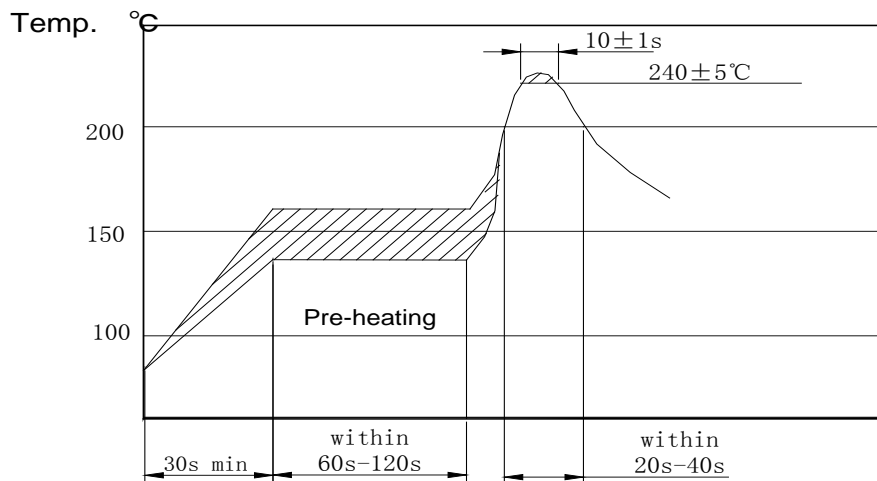

**P/N: WTL6R24358RH**  
**7.0\*3.0\*1.5/ceramic filter**



8. PACKAGE

To protect the products in storage and transportation, it is necessary to pack them (outer and inner package) .

8.1 On paper pack, the following requirements are requested.

8.1.1 Dimensions and Mark

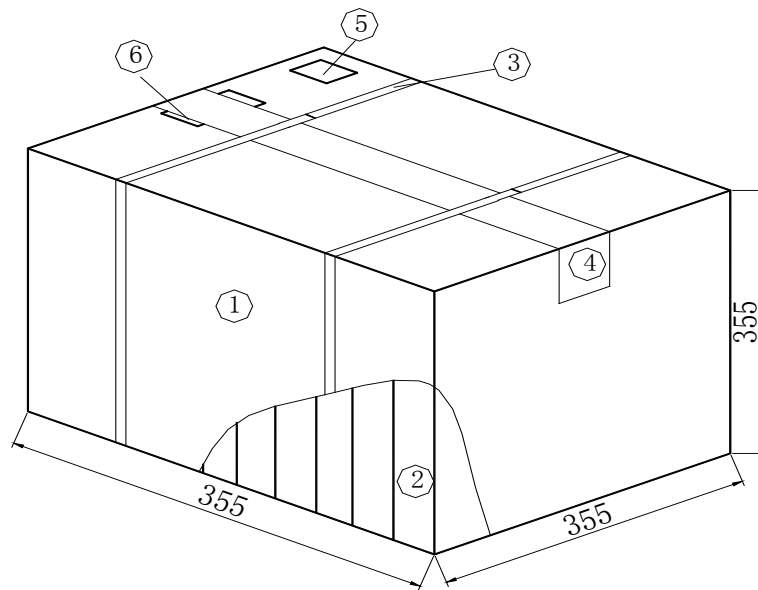

NO.	Name	Quantity
①	Package	1
②	Inner Box	12
③	Belt	2.9 m
④	Adhesive tape	1.2 m
⑤	Label	1
⑥	Certificate of approval	1

8.1.2 Section of package

Package is made of corrugated paper with thickness of 0.8cm. Package has 10 inner boxes, each box has 1 reels (each reel for plastic bag).

8.1.3 Quantity of package

Per plastic reel                      4000 pieces of piezoelectric ceramic part

<http://www.wtlcrystals.com>      Email:WTL006@wtlcrystals.com      Tel:86-755-82677582

Fax:86-755-82679302

**P/N: WTL6R24358RH**  
**7.0\*3.0\*1.5/ceramic filter**



Per inner box                    1 reel  
 Per package                    10 inner boxes  
 (40000 pieces of piezoelectric ceramic part)

8.1.4 Inner Box Dimensions

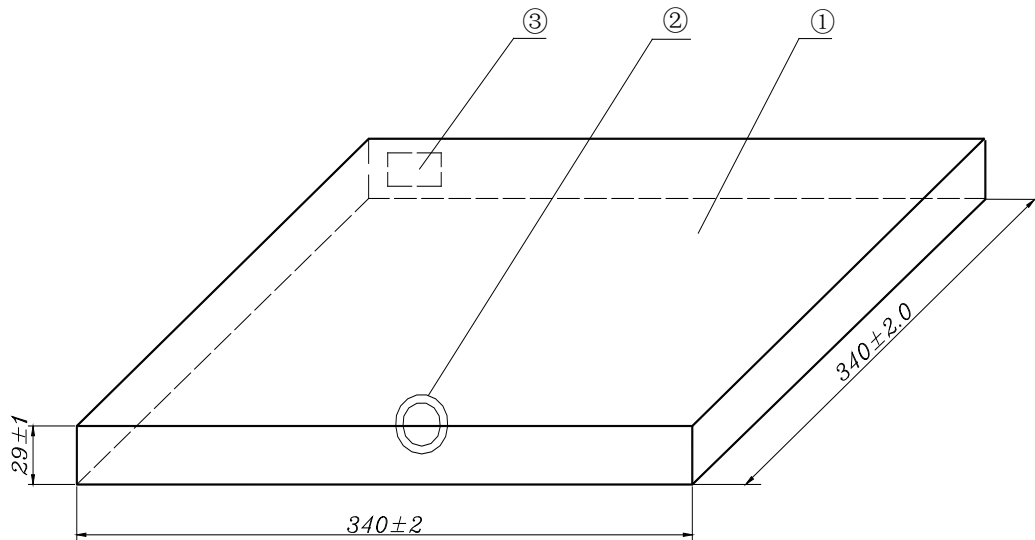

NO.	Name	Quantity
①	Inner Box	1
②	QC Label	1
③	Label	1

8.2 On reel pack, the following requirements are requested.

8.2.1 Reel



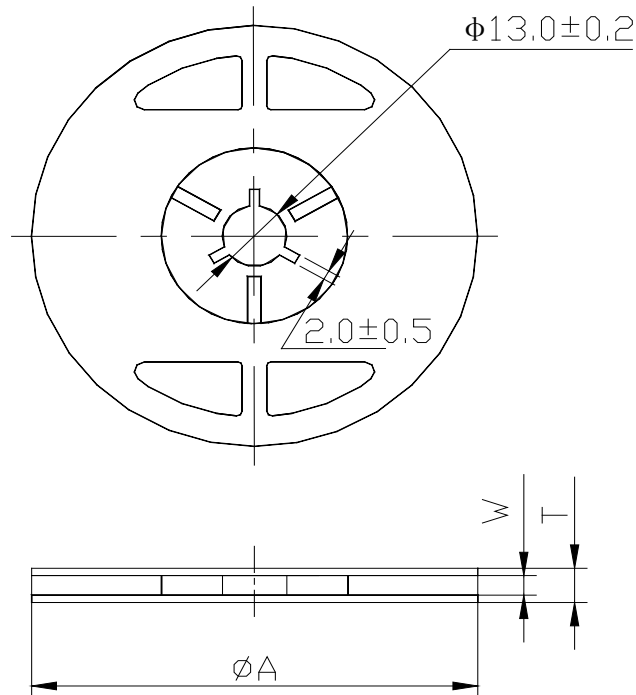

$\phi A$	W	T	Pieces per reel	Carrier tape size
$330 \pm 3$	16.4min	22.4max	4000typ.	16

### 8.2.3 Packing Method Sketch Map

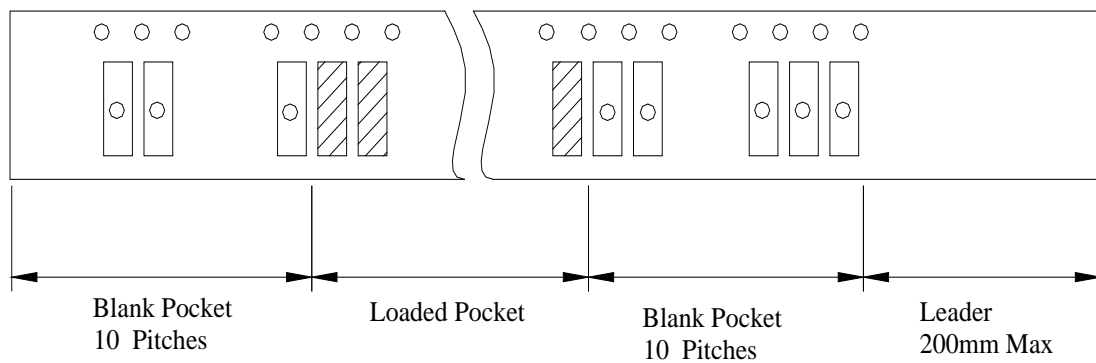

8.2.4 Test Condition Of Peeling Strength

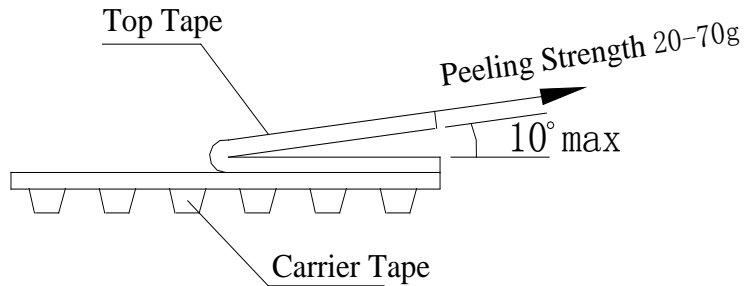

9. EIAJ Monthly Code

2005 / 2007 / 2009		2006 / 2008 / 2010	
MONTH	CODE	MONTH	CODE
JAN	A	JAN	N
FEB	B	FEB	P
MAR	C	MAR	Q
APR	D	APR	R
MAY	E	MAY	S
JUN	F	JUN	T
JUL	G	JUL	U
AUG	H	AUG	V
SEP	J	SEP	W
OCT	K	OCT	X
NOV	L	NOV	Y
DEC	M	DEC	Z

10. OTHER

10.1 Caution

10.1.1 Don't apply excess mechanical stress to the component and terminals at soldering. Do not use this product with bend.

10.1.2 Do not clean or wash the component for it is not hermetically sealed.

10.1.3 Do not use strong acidity flux, more than 0.2wt% chlorine content, in flow soldering.

10.1.4 Don't be close to fire.

10.1.5 This specification mentions the quality of the component as a single unit. Please insure the component is thoroughly evaluated in your application circuit

10.1.6 Expire date (Shelf life) of the products is 12 months after delivery under the

**P/N: WTL6R24358RH**  
**7.0\*3.0\*1.5/ceramic filter**

---



conditions of a sealed and an unopened package. Please use the products within 12 months after delivery. If you store the products for a long time (more than 12 months), use carefully because the products may be degraded in the solder-ability or rusty. Please confirm solder-ability and characteristics for the products regularly.

10.1.7 Exposure components under soldering condition that is exceeding our recommendation will increase the failure dangerous.

10.1.8 Please contact us before using the product as automobile electronic component.

10.2 Notice

10.2.1 Please return one of these specifications after your signature of acceptance.

10.2.2 When something gets doubtful with this specifications, we shall jointly work to get an agreement.