

243 Brick Fuse

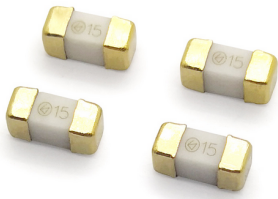

Dimensions(unit:mm)

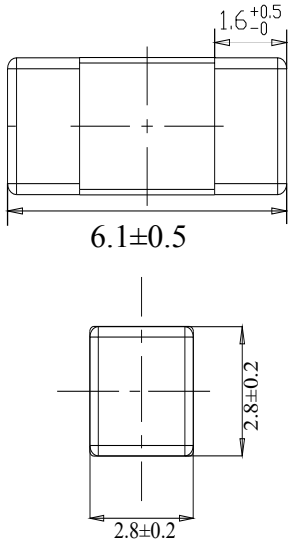

Main Characteristics

Brick Fuse;Fast-acting(F)

Standard

UL248-14

Materials

Body: Ceramic
End Caps:Copper plated with gold

Operating Temperature

-55°C to +125°C

Stock Temperature

+10°C to +60°C

Relative humidity:≤75% yearly average
Without dew, maximum 30 days at 95%

Vibration Resistance

24 cycles at 15 min. each (60068-6)
10-60Hz at 0.75mm amplitude
60-2000Hz at 10g acceleration

Soldering Parameters

260°C. ≤10 sec (Wave Soldering)
350°C. ≤3 sec (Hand Soldering)
Soldering Peak:
260°C. 10 sec.
280°C. 5 sec. (IEC 60068-20)

Average Time Current (I-T) Curves

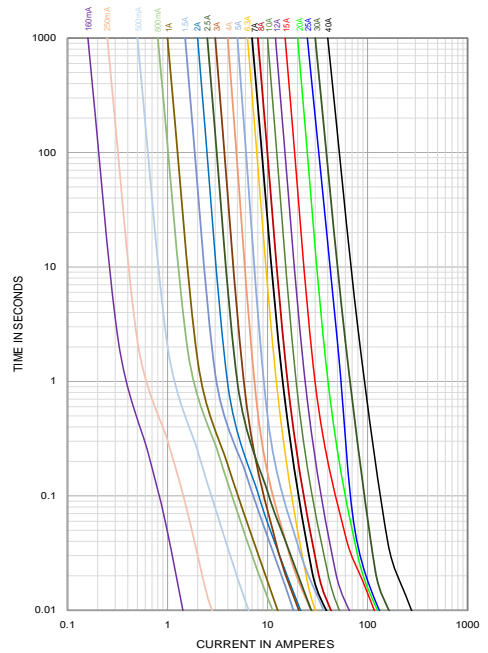

Time vs Current Characteristics: UL248-14

Rated Current	100%	200%
100mA~40A	>4h	<5s



Amp Code	Rated Current	Rated Voltage	Typical Voltage Drop Max(mV)	Breaking Capacity	Typical Melting I2T(A2s)	Typical cold Resistance mΩ	Approvals		
							cURus		
0160	160mA	86/100/125V DC 125/250V AC	800	10KA@86VDC 50A@250VAC 300A@125VDC	0.015	2254.0	●		
0250	250mA		500		0.083	799.3	●		
0500	500mA		250		0.480	274.8	●		
0800	800mA		200		1.4	128.3	●		
1100	1.00A		200		1.8	97.1	●		
1150	1.50A		200		3.7	60.0	●		
1200	2.00A		150		4.7	37.0	●		
1250	2.50A		150		7.7	28.6	●		
1300	3.00A		150		3.7	22.1	●		
1400	4.00A		150		6.1	16.25	●		
1500	5.00A		150		11.9	13.79	●		
1630	6.30A		100		8.3	9.19	●		
1700	7.00A		100		12.5	8.68	●		
1800	8.00A		100		16.2	6.88	●		
2100	10.0A		100		23.3	5.57	●		
2120	12.0A		100		39.3	4.52	●		
2150	15.0A		86/100/125V DC		100	10KA@86VDC 300A@125VDC	130.5	3.86	●
2200	20.0A				100	140.0	2.53	●	
2250	25.0A	100		300A@125VDC 500A@86VDC/100VDC	170.6	2.10	●		
2300	30.0A	100		270.0	1.65	●			
2400	40.0A	100		724.8	1.13	●			

Note: (1) Permissible continuous operating current is ≤100% at ambient temperature of 23°C (73.4°F)
(2) The current values used for calculating I2T should be within the standard 10In.

Ordering Information

Series	Amp Code	Supplementary Code	Qty
243			



Sales Contact
sls01@betterfuse.com

Technical Support
Kenny@betterfuse.com

National High-tech Enterprise
SC 32C National Technical
Committee Member of China
Intertek ISO 9001 Certified Company
Intertek ISO 14001 Certified Company
Intertek QC 080000 Certified Company
NQA IATF 16949 Certified Company

国家高新技术企业
SC 32C 国内专家组成员单位
ISO 9001 认证企业
ISO 14001 认证企业
QC 080000 认证企业
IATF 16949 认证体系