

254 Brick Fuse

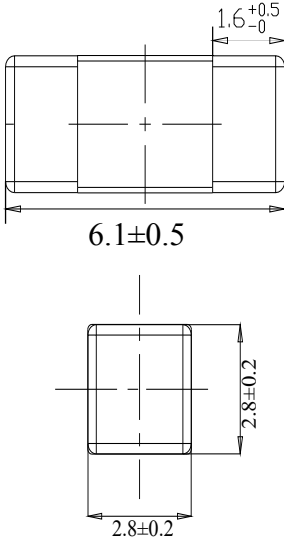

Dimensions(unit:mm)



Main Characteristics

Brick Fuse;Time-lag(T)

Standard

UL248-14

Materials

Body: Ceramic
End Caps:Copper plated with gold

Operating Temperature

-55°C to +125°C

Stock Temperature

+10°C to +60°C

Relative humidity:≤75% yearly average
Without dew, maximum 30 days at 95%

Vibration Resistance

24 cycles at 15 min. each (60068-6)
10-60Hz at 0.75mm amplitude
60-2000Hz at 10g acceleration

Soldering Parameters

260°C. ≤10 sec (Wave Soldering)
350°C. ≤3 sec (Hand Soldering)
Soldering Peak:
260°C. 10 sec.
280°C. 5 sec. (IEC 60068-20)

Average Current Curve(I-T Curves)

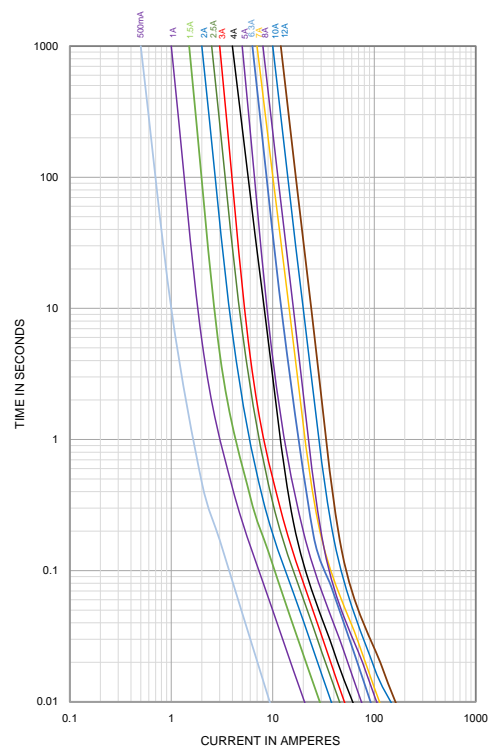

Time vs Current Characteristics: UL248-14

| | | |
|---------------|------|------|
| Rated Current | 100% | 200% |
| 500mA~12A | >4h | <60s |



Electrical Characteristics at 25°C

| Amp Code | Rated Current | Rated Voltage | Typical Voltage Drop Max(mV) | Breaking Capacity | Typical Melting I ² T (A ² s) | Typical cold Resistance (mΩ) | Approvals | Marking |
|----------|---------------|------------------|------------------------------|---------------------------|---|------------------------------|-----------|---------|
| | | | | | | | cURus | |
| 0500 | 500mA | 250VAC 125VDC | 150 | 50A@250VAC 300A@125VDC | 0.84 | 217.3 | • | Ⓢ 500 |
| 1100 | 1.00A | | 150 | | 4.10 | 83.2 | • | Ⓢ 1 |
| 1150 | 1.50A | | 150 | | 8.37 | 45.1 | • | Ⓢ 1.5 |
| 1200 | 2.00A | | 110 | | 13.9 | 31.5 | • | Ⓢ 2 |
| 1250 | 2.50A | | 110 | | 20.5 | 23.2 | • | Ⓢ 2.5 |
| 1300 | 3.00A | | 110 | | 25.5 | 20.2 | • | Ⓢ 3 |
| 1400 | 4.00A | | 110 | | 37.0 | 13.6 | • | Ⓢ 4 |
| 1500 | 5.00A | | 110 | | 55.0 | 10.2 | • | Ⓢ 5 |
| 1630 | 6.30A | | 110 | | 82.3 | 7.16 | • | Ⓢ 6.3 |
| 1700 | 7.00A | | 110 | | 125.9 | 6.50 | • | Ⓢ 7 |
| 1800 | 8.00A | | 110 | | 111.0 | 5.65 | • | Ⓢ 8 |
| 2100 | 10.00A | | 110 | | 216.6 | 4.60 | • | Ⓢ 10 |
| 2120 | 12.00A | 110 | 263.1 | 3.65 | • | Ⓢ 12 | | |

Note: (1) Permissible continuous operating current is ≤100% at ambient temperature of 23°C (73.4°F)
(2) The current values used for calculating I²T should be within the standard range of 8ms ~ 10ms.

Ordering Information

| Series | Amp Code | Supplementary Code | Qty |
|--------|----------|--------------------|-----|
| 254 | | | |



Sales Contact
sls01@betterfuse.com

Technical Support
Kennyy@betterfuse.com

National High-tech Enterprise
SC 32C National Technical Committee Member of China
Intertek ISO 9001 Certified Company
Intertek ISO 14001 Certified Company
Intertek QC 080000 Certified Company
NQA IATF 16949 Certified Company

国家高新技术企业
SC 32C 国内专家组成员单位
ISO 9001 认证企业
ISO 14001 认证企业
QC 080000 认证企业
IATF 16949 认证体系