



RSZ307-1-T2Z 1000VDC 直流快速熔断器

*$P_t$  值小，高分断能力，低电弧电压*

# 产品规格书

(2017-01)

公司地址：西安市丈八五路现代企业中心东区 3-10303

邮政编码：710077

电 话：029—68590655

029—68590656

传 真：029—68590676

电子邮件：[zrchina@sinfuse.com](mailto:zrchina@sinfuse.com)

公司网址：[www.sinfuse.com](http://www.sinfuse.com)

## ◎ 产品基本资料

- IEC/DIN 标准方体结构，快速熔断器，性能符合 GB13539、IEC60269。
- 额定电压：DC 1000V                      ● 额定电流：125-500A
- 保护类别：aR (IEC)                      ● 分断能力：DC 50kA    L/R=10~15ms
- 符合欧盟和中国 RoHS 指令

## ◎ 产品的规格表及参数-安装尺寸图

无指示 型号规格	基座指示 型号规格	额定电流 (A)
RSZ307-1-T2Z-125A1000V-N	RSZ307-1-T2Z-125A1000V	125
RSZ307-1-T2Z-160A1000V-N	RSZ307-1-T2Z-160A1000V	160
RSZ307-1-T2Z-200A1000V-N	RSZ307-1-T2Z-200A1000V	200
RSZ307-1-T2Z-250A1000V-N	RSZ307-1-T2Z-250A1000V	250
RSZ307-1-T2Z-315A1000V-N	RSZ307-1-T2Z-315A1000V	315
RSZ307-1-T2Z-350A1000V-N	RSZ307-1-T2Z-350A1000V	350
RSZ307-1-T2Z-400A1000V-N	RSZ307-1-T2Z-400A1000V	400
RSZ307-1-T2Z-450A1000V-N	RSZ307-1-T2Z-450A1000V	450
RSZ307-1-T2Z-500A1000V-N	RSZ307-1-T2Z-500A1000V	500

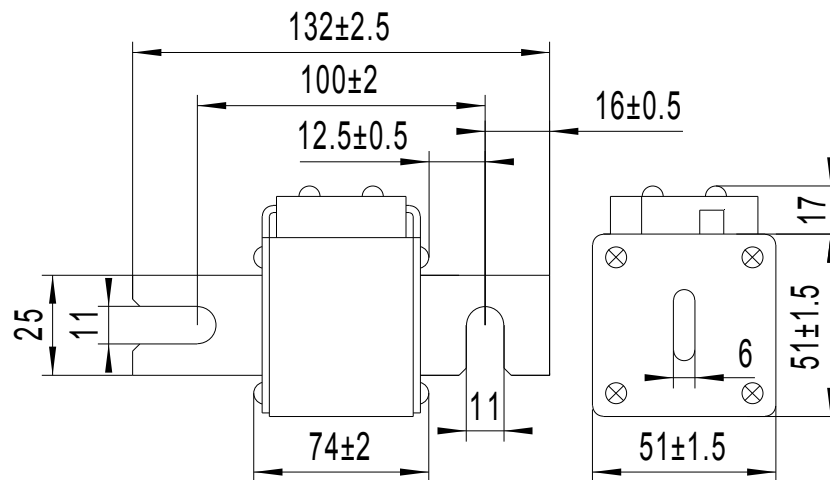

## 配用开关:

型号	额定电压	额定电流	最小电压	最小电流
WDK-Y	250V	5A	10V	10mA
WDK-J	125V	0.1A	10V	1mA

As a security part for overcurrent protection, fuses are often used in various types and specifications of energy storage systems and subsystems or equipment, including portable power bank, stacking home or residential storage system, industrial and commercial energy storage system, containerized energy storage system etc..

## I. Fuses In Industrial Containerized ESS

In order to show the application of the fuse in the energy storage system more intuitively, let's take the industrial containerized energy storage system as an example:



A battery module or battery pack consists of numerous individual battery cells, multiple battery modules forming a battery cluster, and multiple series connected battery clusters forming the entire energy storage system. The layout of fuses in large containerized energy storage systems is as follows:

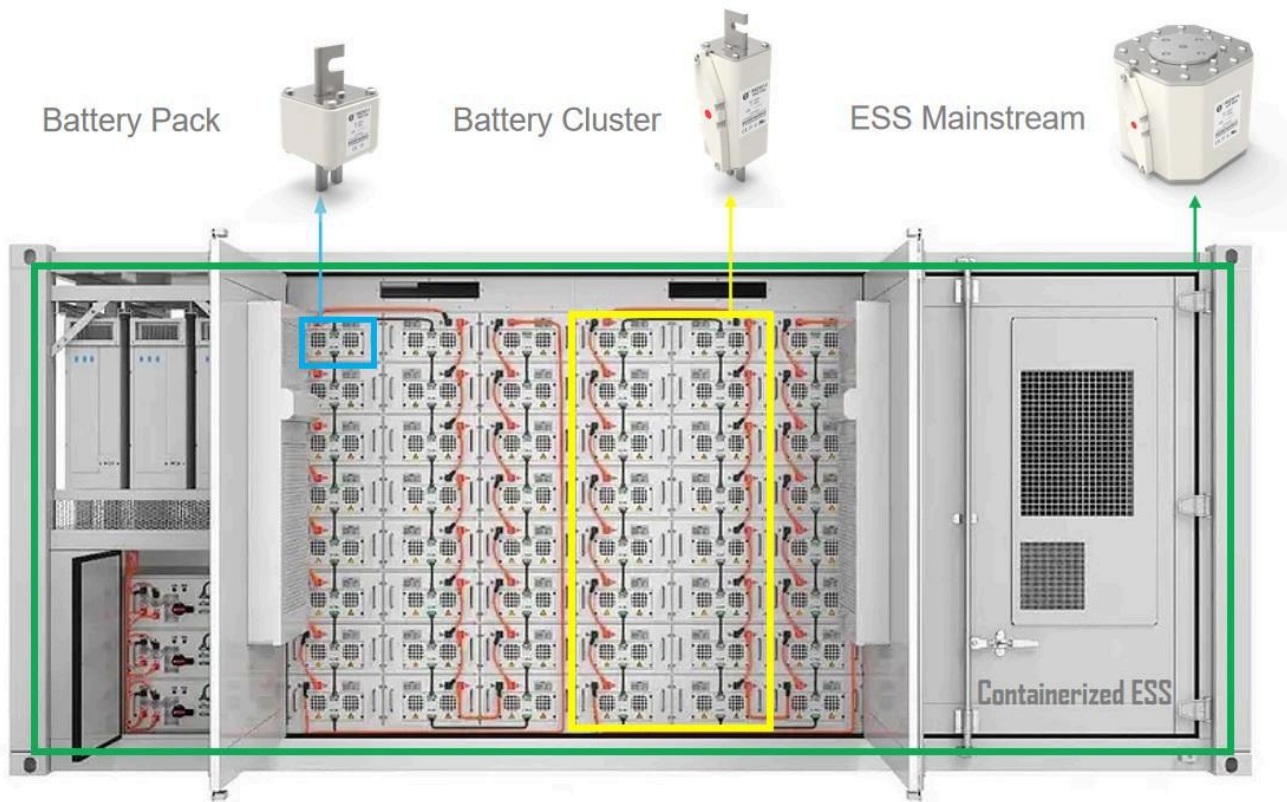

### [RSZ307-1-TMZ](#) (For Battery Pack)

The fuses distributed in the battery module or battery pack of the energy storage system are used for branch current control protection; Usually, one fuse is used in each battery module.

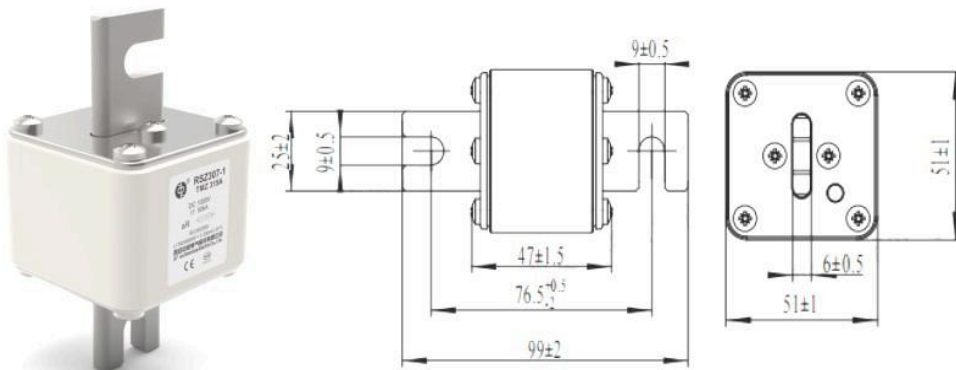

\*Rated voltage: DC250V

\*Rated current: 200~450A

\*Segmentation capacity: DC50kA (10~15ms)

\*Compliant with standards: IEC60269, IEC60077, UL248

\*Weight: approximately 400g

\*Packing Info.: 30pcs per carton

\*Ordering Part Number: RSZ307-1-TMZ-200A250V-N、RSZ307-1-TMZ-250A250V-N、RSZ307-1-TMZ-315A250V-N、RSZ307-1-TMZ-350A250V-N、RSZ307-1-TMZ-400A250V-N、RSZ307-1-TMZ-450A250V-N

### RSZ307-2-RAZ/RSZ307-2-QAZ (For Battery Cluster)

Commonly used in battery cluster columns. Each battery cluster uses a fuse as overcurrent protection, with the following parameters:

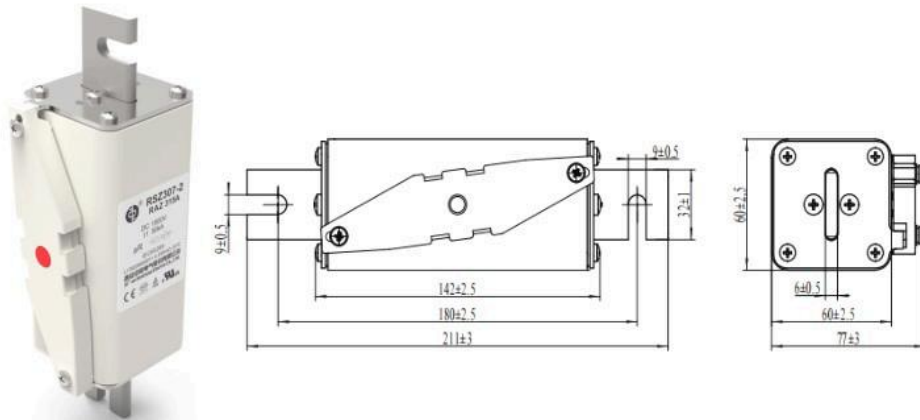

\*Rated voltage: DC1500V

\*Rated current: 100~450A

\*Segmentation capacity: DC 150kA (10~15ms)

\*Compliant with standards: IEC60269, UL248

\*Weight: 1500g±10%

\*Packing Info.: 6pcs per carton

\*Ordering Part Number:RSZ307-2-RAZ-100A1500V、RSZ307-2-RAZ-125A1500V、RSZ307-2-RAZ-160A1500V、RSZ307-2-RAZ-200A1500V、RSZ307-2-RAZ-250A1500V、RSZ307-2-RAZ-315A1500V、RSZ307-2-RAZ-350A1500V、RSZ307-2-RAZ-400A1500V、RSZ307-2-RAZ-450A1500V；RSZ307-2-QAZ-100A1500V、RSZ307-2-QAZ-125A1500V、RSZ307-2-QAZ-160A1500V、RSZ307-2-QAZ-200A1500V、RSZ307-2-QAZ-250A1500V、RSZ307-2-QAZ-315A1500V、RSZ307-2-QAZ-350A1500V、RSZ307-2-QAZ-400A1500V、RSZ307-2-QAZ-450A1500V

### **RSZ307-5-DAV** (For Mainstream Cabinet)

Used in the overall cabinet of the energy storage system. A fuse is used in the main circuit of the energy storage system as the overall safety protection and control of the system, with the following parameters:

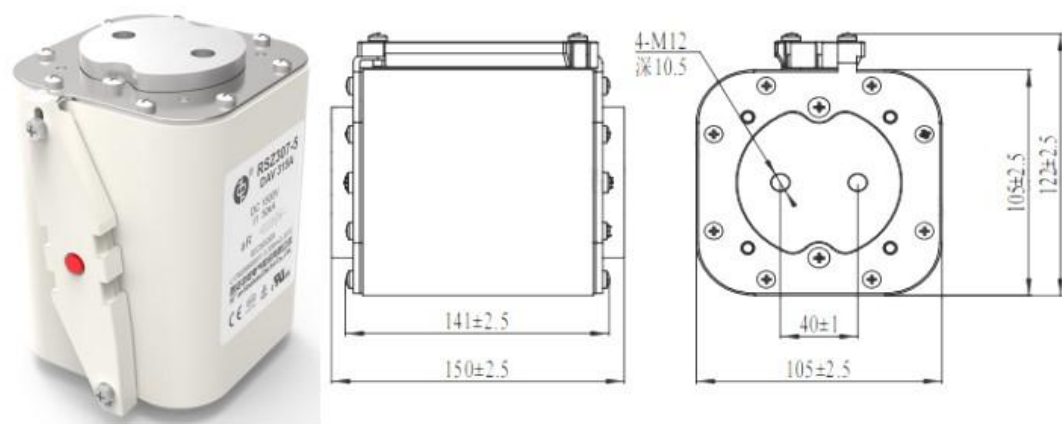

\*Rated voltage: DC1500V

\*Rated current: 450~1800A

\*Segmentation capacity: DC 150kA (10~15ms) / DC 250kA (≤ 4ms)

\*Compliant with standards: IEC60269, UL248

\*Weight: 4430g±100

\*Packing Info.: 1piece per box, 2pcs per carton

\*Ordering Part Number: RSZ307-5-DAV-450A1500V、RSZ307-5-DAV-500A1500V、RSZ307-5-DAV-550A1500V、RSZ307-5-DAV-630A1500V、RSZ307-5-DAV-700A1500V、RSZ307-5-DAV-800A1500V、RSZ307-5-DAV-450A900V、RSZ307-5-DAV-1000A1500V、RSZ307-5-DAV-1100A1500V、RSZ307-5-DAV-1250A1500V、RSZ307-5-DAV-1400A1500V、RSZ307-5-DAV-1500A1500V、RSZ307-5-DAV-450A1600V、RSZ307-5-DAV-450A1800V

### **RSZ307-N-UJP** (For ESS Cabinet)

Used in the overall cabinet of the energy storage system, with the following parameters:

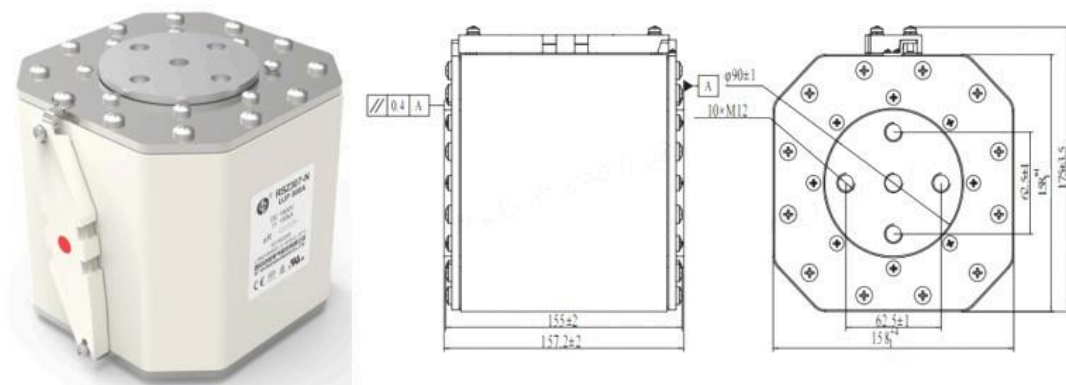

\*Rated voltage: DC1500V

\*Rated current: 3000A

\*Segmentation capacity: DC 150kA (10ms) / DC 250kA (4ms)

\*Compliant with standard: IEC60269

\*Weight: approximately 12055g

\*Packing Info.: 1piece per carton

\*Match with WDK-Y auxiliary contact micro switch.

\*Ordering Part Number: RSZ307-N-UJP-1250A1500V, RSZ307-N-UJP-1400A1500V, RSZ307-N-UJP-1500A1500V, RSZ307-N-UJP-1600A1500V, RSZ307-N-UJP-1800A1500V, RSZ307-N-UJP-2000A1500V, RSZ307-N-UJP-2200A1500V, RSZ307-N-UJP-2400A1500V, RSZ307-N-UJP-2500A1500V, RSZ307-N-UJP-2600A1500V, RSZ307-N-UJP-2800A1500V, RSZ307-N-UJP-3000A1500V







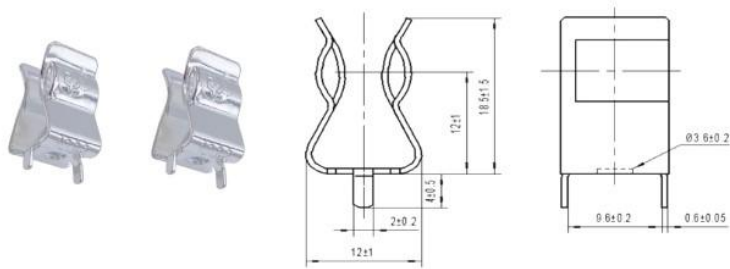

**Description:** PCB Clips for fuse, including EV325-3EC (1 fuse with 2 clips).

\* [RS309-MF-S Series Fuses](#)

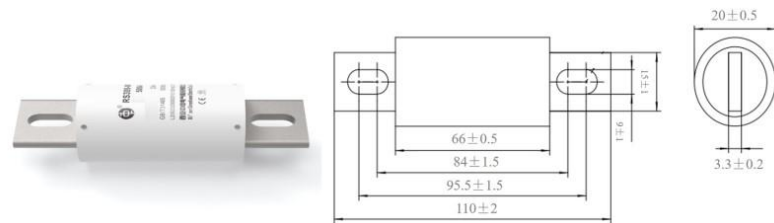

**Features:** Rated voltage AC/DC700V, rated current 70~800A optional; segment capacity AC100kA/DC50kA (time constant 10-15ms); Products meet RoHS, has CE and UL certifications.

\* [RS308-HB-4B Series Fuses](#)

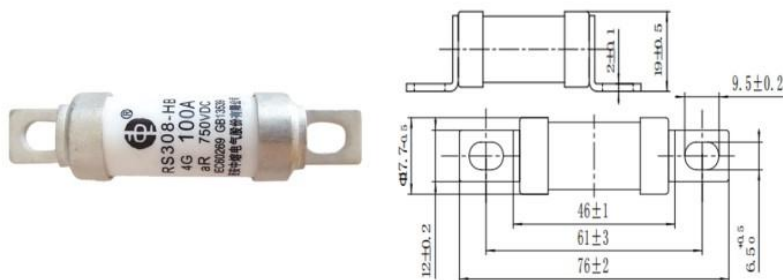

**Description:** Rated voltage DC750V/AC800V, rated current 10A-100A optional; Featuring strong current limiting and high breaking capacity [DC50kA (time constant 10ms)/AC100kA, power factor 0.2]; Product complies with RoHS and has CE, UL, and TUV

certifications.

**Notes:** Other part numbers also include RS308-HB-4G, RS308-HB-4GB, RS308-HB-2H, RS308-HB-5M, RS308-HB-5N, RS308-HB-GG, RS308-HB-NN - rated voltage of DC550V/AC690V with rated current of 10A-710A optional.

### III. Fuses In ESS Subsystems

Fuses are used in the inverter module of energy storage systems.



\* [RS306-01-T5Z Series Fuses](#)

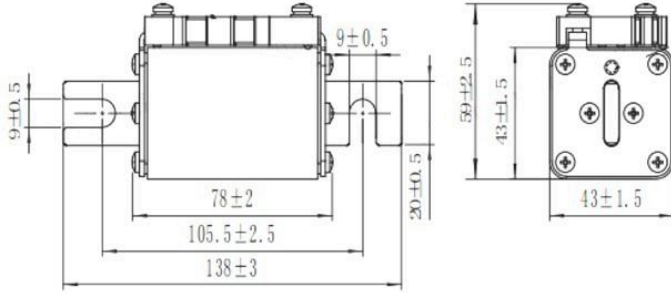

**Features:** RS306-01-T5Z fuses comply with RoHS and has CCC, UL and CE certifications.

#### IV. Fuses In ESS MSD

MSD (Manual Service Disconnect) is a high-voltage connector with a fuse inside, which can achieve electrical isolation of high-voltage systems and also serve as short circuit protection. In another words, the fuse inside of MSD disconnect the high-voltage connection and protect the safety of personnel during maintenance of the ESS high-voltage system.

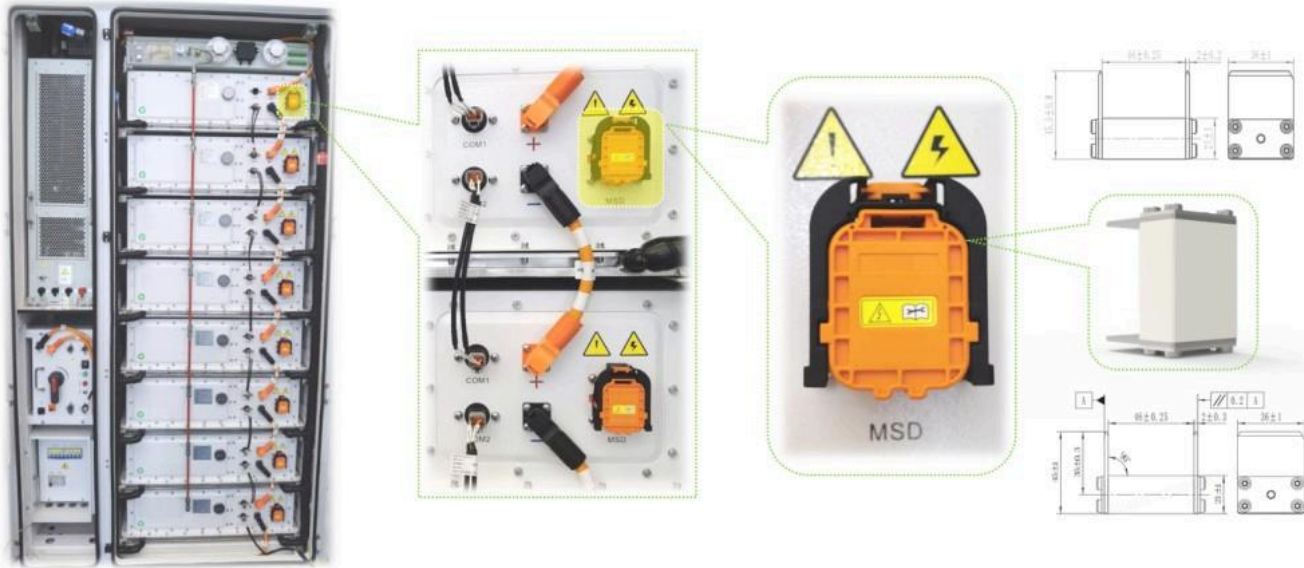

\*RSZ307-000-LGH(160A~400A)DC250V

\*RS306-000-EV(21A~400A)DC750V

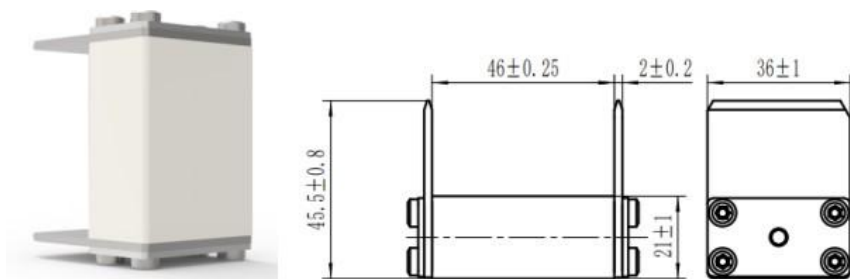

**Features:** Compact size, designed for ESS MSD. The typical rated voltage of fuses in MSD include DC250V, DC750V and DC1,500V with rated current range 21A~400A.

**In addition, in other energy storage systems with different principles or types, as well as other subsystem application scenarios such as high-voltage boxes, PCS, BMS, EMS etc., fuses as "Safety Guard" also play an important role. Fuse models include: RS309-MD, RSZ307-000-L2N, RSZ307-1-S5P, RSZ307-2-AT5Z, RSZ307-3-RAZ, RSZ307-5-W7P series etc..**